



MCE 400

Operating instruction and Spare parts list

IMPORTANT SAFETY INSTRUCTIONS

WARNING To guard against injury, basic safety precautions should be observed, including the following.

- 1) READ AND FOLLOW ALL SAFETY INSTRUCTIONS.
- 2) DANGER – To avoid possible electric shock, special care should be taken since water is employed in the use of aquarium equipment. For each of the following situations, do not attempt repairs by yourself; return the appliance to an authorized service facility for service or discard the appliance.
 - a) If the appliance shows any sign of abnormal water leakage, immediately unplug it from the power source. (Immersible equipment only)
 - b) Carefully examine the appliance after installation. It should not be plugged in if there is water on parts not intended to be wet.
 - c) Do not operate any appliance if it has a damaged cord or plug, or if it is malfunctioning or has been dropped or damaged in any manner.
 - d) To avoid the possibility of the appliance plug or receptacle getting wet, position aquarium stand and tank to one side of a wall-mounted receptacle to prevent water from dripping onto the receptacle or plug.

A “drip-loop”, shown in the figure below, should be arranged by the user for each cord connecting an aquarium appliance to a receptacle. The “drip-loop” is that part of the cord below the level of the receptacle, or the connector if an extension cord is used, to prevent water travelling along the cord and coming in contact with the receptacle.

If the plug or socket does get wet, **DON'T** unplug the cord. Disconnect the fuse or circuit breaker that supplies power to the appliance. Then unplug and examine for presence of water in the receptacle.

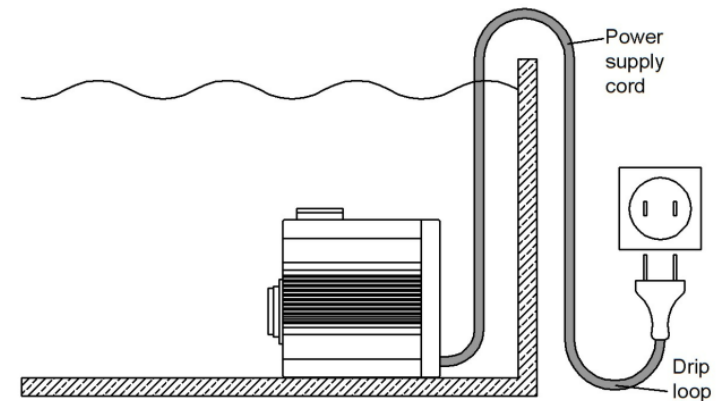

- 3) Close supervision is necessary when any appliance is used by or near children.
- 4) Always unplug an appliance from an outlet when not in use, before putting on or taking off parts, and before cleaning. Never yank cord to pull plug from outlet. Grasp the plug and pull to disconnect.
- 5) Do not use an appliance for other than intended use. The use of attachments not recommended or sold by the appliance manufacturer may cause an unsafe condition.
- 6) Make sure an appliance mounted on a tank is securely installed before operating it.
- 7) Read and observe all the important notices on the appliance.
- 8) If an extension cord is necessary, a cord with a proper rating should be used. A cord rated for less amperes or watts than the appliance rating may overheat. Care should be taken to arrange the cord so that it will not be tripped over or pulled.
- 9) This appliance has a polarized plug (one blade is wider than the other). As safety feature, this plug will fit in a polarized outlet only one way. If the plug does not fit, contact a qualified electrician. Never use with an extension cord unless plug can be fully inserted. Do not attempt to defeat this safety feature.

Exception: This instruction may be omitted for an appliance that is not provided with a polarized attachment plug.

Removing of the plug invalidates the warranty!

SAVE THESE INSTRUCTIONS

Deltec *External Protein Skimmer MCE 400*

Operating Instructions

The Multi Compact External skimmer is ideal for 'hang on' installation directly onto the outside of the aquarium or sump and requires no further supply pump for highly efficient operation.

Assembly

The skimmer has been packed in a partially disassembled state to prevent damage in transit. Study the diagram overleaf to reassemble. Do not switch on the recirculation pump however unless the pump is immersed or flooded with water.

Important

Before you install the unit in position fill the body with fresh water from the mains supply to ensure that there has not been any damage in transit.

Installation

Hang the skimmer body on the outside of the aquarium in a suitable position. The inlet pipe is fitted with a strainer on one end, which simply pulls off for future cleaning.

- remove the skimmer cup
- fill the skimmer with aquarium water to just below the pipe openings in the skimmer body
- insert the 40 mm outlet pipe (No. 16) with a slightly twisting motion into the skimmer body
- push the degassing plate (No. 20) into the outlet pipe
- push the 20 mm suction pipe (No. 18) through the skimmers pipe adaptor into the suction elbow inside the skimmer body.
- Close the air tap
- Insert the foam cup into the skimmer by app 50 mm
- Start the pump, after a short while the pump and the suction pipe will be bled of all air
- Open the air tap
- The skimmer is now ready for operation
- Make sure that both silicone hoses are not blocked or kniked.

Operation and setting

Leave the skimmer to settle down for a day or so before fine adjustment. After two to three days, or earlier in a previously unskimmed tank, a thick brown foam will be produced at the neck of the skimmer. Move the skimmer cup up or down to collect this foam. Moving the cup downwards will result in an increased quantity of wetter foam and moving it up a darker. The screw No. 21 can be adjusted to create a slight pressure to fix the skimmer cup in position It is recommended that the skimmer cup is emptied every 2-4 days or as required. The cup should be wiped clean of any fatty deposits as build up of this waste product will greatly reduce the performance. Whilst cleaning leave the pump switched off, for 15 minutes to allow any salt deposits in the venturi tube to dissolve.

Use with ozone

Deltec skimmers are suitable for use with ozone and will automatically suck the gas through the venturi hose. A maximum volume of 25 mg/h should be used on tank volumes that are suitable for this skimmer. Do not use excessive ozone, as it is dangerous and can cause severe headaches.

Maintenance

The Deltec skimmer range should require very little adjustment and maintenance. Due to the high levels of calcium in marine aquariums and large volumes of air drawn in, it is common for deposits to accumulate. Regular introduction of a small amount of RO water into the inlet tap whilst running may help to prevent any build up of salt and debris in the venturi.

Fault finding

Malfunction	cause	remedy
Pump produces insufficient air	tap, airline or venturi blocked	clean
	airline kinked	remove kink
	ozonizer blocked	clean
excessive air bubbles in aquarium water, often in new installations	caused by additives in certain sea salts and water conditions	use different salt or feed heavily for a period, empty skimmer cup frequently, open air tap fully. This condition may last for several weeks.
	air tap closed to far	open air tap

Technical data	Dimensions (l/w/h) app.	Power consumption	Air flow app.	min. height for sump installation	Aquarium size normal stocking	Aquarium size light stocking
MCE 400	216x77x490mm	9 Watt	350 ltr./h	600mm	400 ltr.	500 ltr.

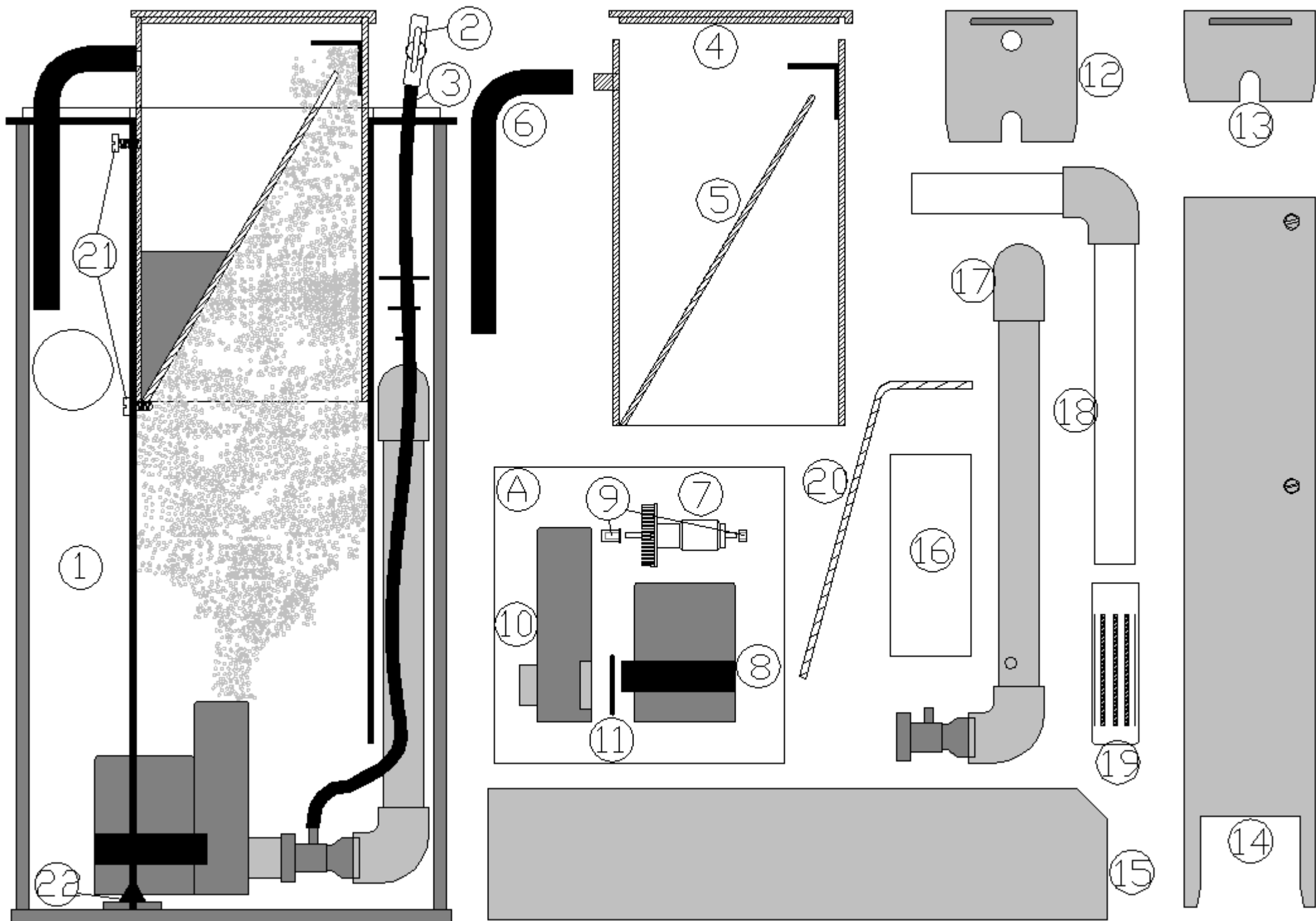

Spare parts list

Nr.	Art. Nr.	Bezeichnung	Description			
A	28017000	Pumpe DCS 400 Komplett	Skimmer pump DCS 400 cpl.			
1	31110100	Gehäuse	Skimmer body only			
2	93010010	Mini Regulierungsventil	Tap			
3	61751042	Silikonschlauch 5/8	Silicon hose 5/8mm			
4	31110300	Schaumtopf Deckel	Lid			
5	31110200	Schaumtopf mit Überlauf	Skimmer cup			
6	61758160	Silikonschlauch 7/10	Media Box optionally			
7	27017000	Laufeinheit DCS 400	Needlewheel DCS 400			
8	26017000	Stator DCS 600	Stator DCS 600			
9		Lager	Bearings			
10	81140400	Pumpengehäuse DCS 400	Pump housing DCS 400			
11	69511000	O-Ring UP 1000	O-Ring UP 1000			
12	31110400	Deckel 1	Lid 1			
13	31110500	Deckel 2	Lid 2			
14	31110600	Halteplatte	Holder plate			
15	31110700	Trennplatte	Separation plate			
16	31110800	Auslassrohr	Outlet pipe			
17	31110900	Ansaugrohr Teil 1	Suction pipe part 2			
18	31115910	Ansaugrohr Teil 2	Suction pipe part 2			
19	10100460	Ansaugkorb	Strainer			
20	31117970	Ablaufschütte	Degassing plate			
21	12350000	Kunststoffschraube M4	Screw M4			
22	25094000	Silikon Fuß	Silicone foot			